

SMD Power Inductor CDH30D14D

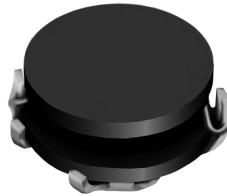

Halogen Free



Description

- Ferrite drum core construction.
- Magnetically unshielded.
- L × W × H: 3.15 × 3.2 × 1.5 mm Max.
- Product weight: 40mg(Ref.)
- Moisture Sensitivity Level: 1
- RoHS compliance.
- Halogen Free available.

Environmental Data

- Operating temperature range: -40°C~+105°C (including coil's self temperature rise)
- Storage temperature range: -40°C~+105°C
- Solder reflow temperature: 260 °C peak.

Packaging

- Carrier tape and reel packaging.
- 13.0" diameter reel
- 4000pcs per reel

Applications

- Ideally used in cell phone, PDA, DVC and DSC.

Dimension - [mm]

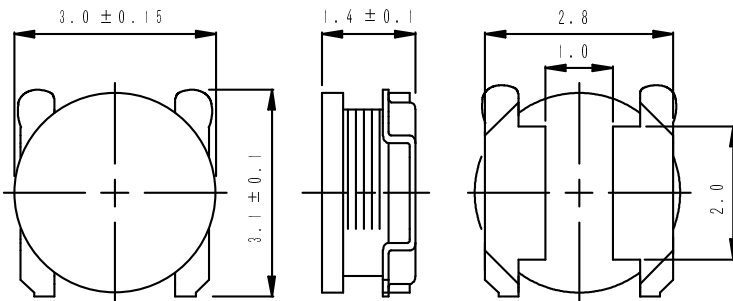

Land pattern and Schematics - [mm]

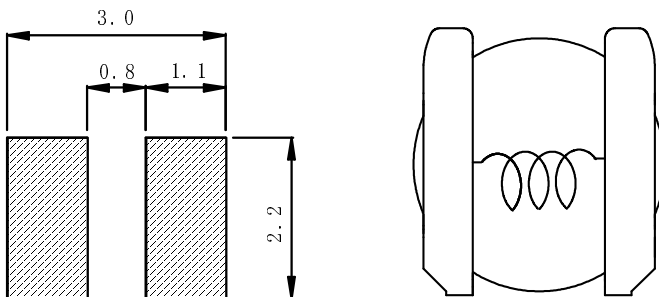

SMD Power Inductor CDH30D14D



Electrical Characteristics

Part No.	Stamp	Inductance (μ H) [Within] ※1	D.C.R. (m Ω) [Within] (at 20°C)	Saturation current (A) ※2		Temperature rise current (A) ※3
				(at20°C)	(at100°C)	
CDH3ØD14DHF-1RØNC	A	1.0 ±30%	48 ±25%	2.66	2.25	2.20
CDH3ØD14DHF-1R6NC	B	1.6 ±30%	66 ±25%	2.19	1.83	1.82
CDH3ØD14DHF-2R2NC	C	2.2 ±30%	87 ±25%	1.89	1.53	1.57
CDH3ØD14DHF-3R3MC	D	3.3 ±20%	121 ±20%	1.53	1.28	1.28
CDH3ØD14DHF-4R7MC	E	4.7 ±20%	206 ±20%	1.23	1.05	1.00
CDH3ØD14DHF-6R8MC	F	6.8 ±20%	271 ±20%	1.05	0.90	0.80
CDH3ØD14DHF-1ØØMC	G	10 ±20%	408 ±20%	0.89	0.74	0.68
CDH3ØD14DHF-15ØMC	H	15 ±20%	613 ±20%	0.68	0.59	0.51

※1. Measuring condition: at 100kHz.

※2. Saturation current: The value of D.C. current when the inductance decreases to 70% of it's nominal value.

※3. Temperature rise current: The value of D.C. current when the temperature rise is $\Delta t=40^{\circ}\text{C}$ ($T_a=20^{\circ}\text{C}$).

SMD Power Inductor CDH30D14D



Saturation Current & Temperature Rise Graph

— L (20°C) — L (105°C) — ΔT

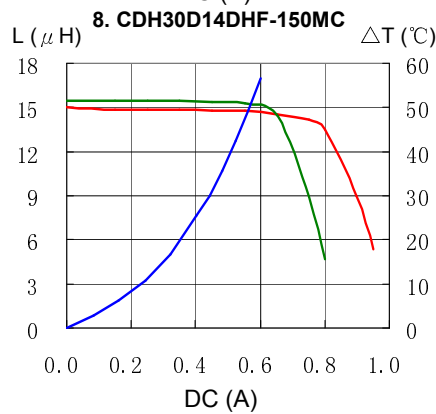
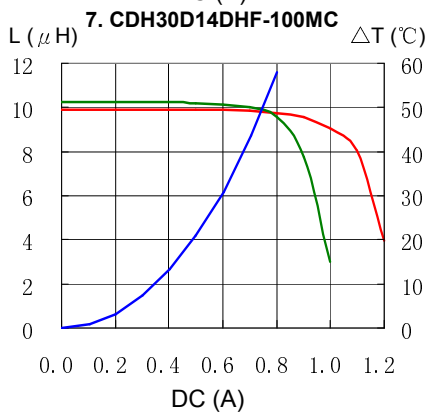
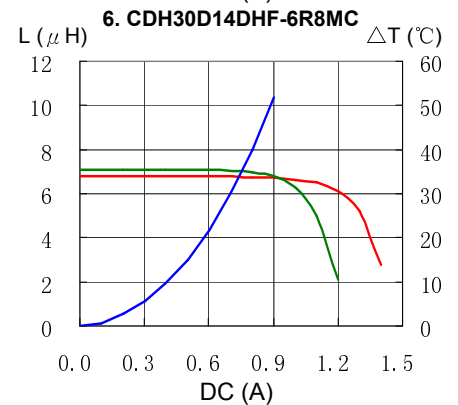
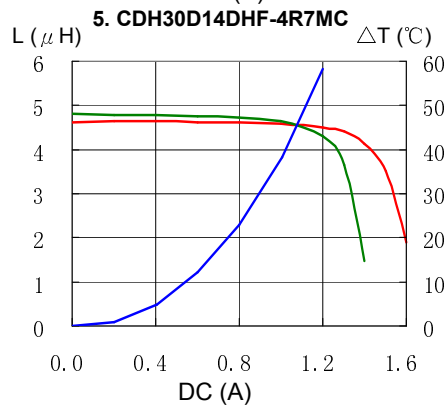
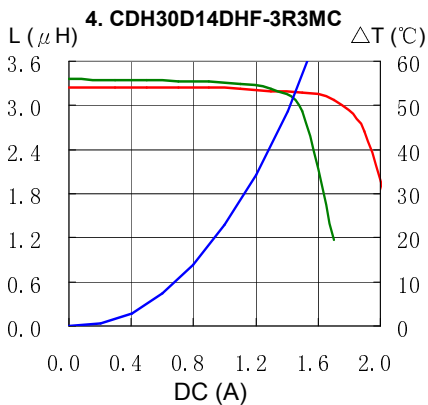
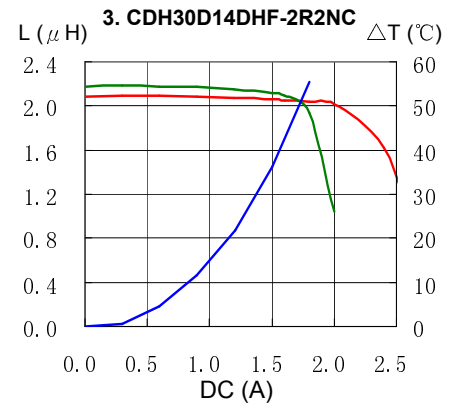
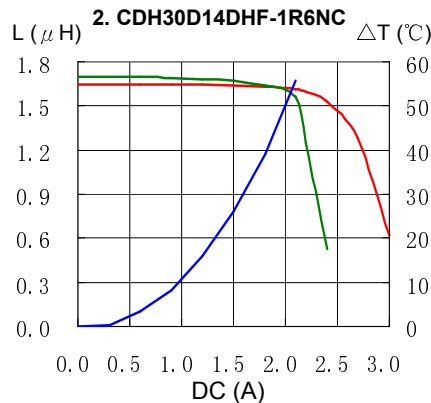
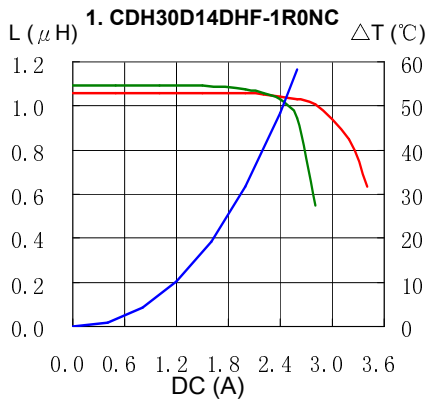

SMD Power Inductor CDH30D14D



Solder Reflow Condition

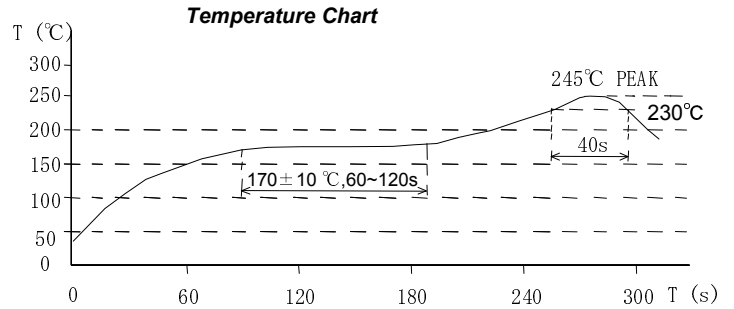
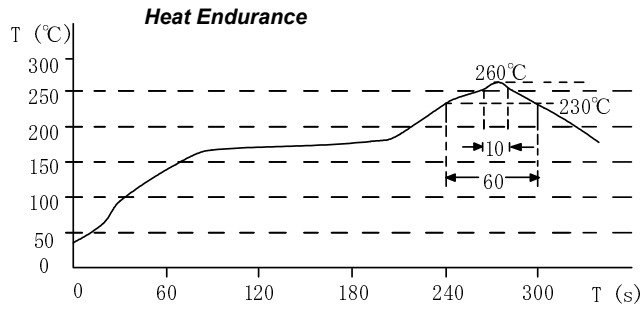

Please refer to the sales offices on our website - <http://www.sumida.com>

Hong Kong

Tel.+852-2880-6781
FAX.+852-2565-9600
sales@hk.sumida.com

Saitama(Japan)

Tel.+81-48-691-7300
FAX.+81-48-691-7340
sales@jp.sumida.com

Chicago

Tel.+1-847-545-6700
FAX. +1-847-545-6720
sales@us.sumida.com

Shanghai

Tel.+86-21-5836-3299
FAX.+86-21-5836-3266
shanghai.sales@cn.sumida.com

Seoul

Tel.+82-2-6237-0777
FAX.+82-2-6237-0778
sales@kr.sumida.com

Oberzell

Tel.+49-8591-937-0
FAX. +49-8591-937-103
contact@eu.sumida.com

Shenzhen

Tel.+86-755-8291-0228
FAX.+86-755-8291-0338
shenzhen.sales@cn.sumida.com

Singapore

Tel.+65-6296-3388
FAX.+65-6841-4426
sales@sg.sumida.com

Neumarkt

Tel.+49-9181-4509-110
FAX. +49-9181-4509-310
infocomp@eu.sumida.com

Taipei

Tel.+886-2-8751-2737
FAX.+886-2-8751-2738
sales@tw.sumida.com

San Jose

Tel.+1-408-321-9660
FAX.+1-408-321-9308
sales@us.sumida.com