

CTRL5480F-1 Series

From 3.9 μH to 22,000 μH

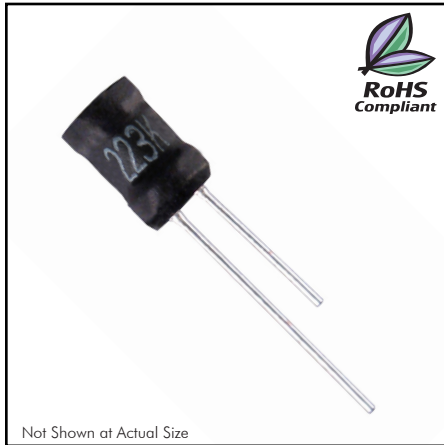

SPECIFICATIONS

Parts are available in $\pm 10\%$ inductance tolerance only.

Part Number	Inductance (μH)	L Test Freq. (KHz)	DCR (Ω) Max.	Saturation Current (A)	Rated Current (A)
CTRL5480F-1-3R9K	3.9	1.0	0.030	1.50	0.800
CTRL5480F-1-4R7K	4.7	1.0	0.034	1.35	0.800
CTRL5480F-1-5R6K	5.6	1.0	0.036	1.25	0.800
CTRL5480F-1-6R8K	6.8	1.0	0.040	1.15	0.800
CTRL5480F-1-8R2K	8.2	1.0	0.054	1.00	0.620
CTRL5480F-1-100K	10	1.0	0.060	0.920	0.620
CTRL5480F-1-120K	12	1.0	0.072	0.840	0.620
CTRL5480F-1-150K	15	1.0	0.078	0.770	0.620
CTRL5480F-1-180K	18	1.0	0.108	0.720	0.490
CTRL5480F-1-220K	22	1.0	0.144	0.660	0.385
CTRL5480F-1-270K	27	1.0	0.168	0.600	0.300
CTRL5480F-1-330K	33	1.0	0.200	0.540	0.300
CTRL5480F-1-390K	39	1.0	0.220	0.470	0.300
CTRL5480F-1-470K	47	1.0	0.240	0.430	0.300
CTRL5480F-1-560K	56	1.0	0.265	0.390	0.300
CTRL5480F-1-680K	68	1.0	0.380	0.360	0.250
CTRL5480F-1-820K	82	1.0	0.445	0.330	0.250
CTRL5480F-1-101K	100	1.0	0.590	0.300	0.190
CTRL5480F-1-121K	120	1.0	0.640	0.270	0.190
CTRL5480F-1-151K	150	1.0	0.730	0.245	0.190
CTRL5480F-1-181K	180	1.0	0.850	0.220	0.190
CTRL5480F-1-221K	220	1.0	1.20	0.190	0.150
CTRL5480F-1-271K	270	1.0	1.32	0.180	0.150
CTRL5480F-1-331K	330	1.0	1.75	0.165	0.120
CTRL5480F-1-391K	390	1.0	1.95	0.150	0.120
CTRL5480F-1-471K	470	1.0	2.00	0.140	0.120
CTRL5480F-1-561K	560	1.0	2.90	0.125	0.095
CTRL5480F-1-681K	680	1.0	3.10	0.110	0.095
CTRL5480F-1-821K	820	1.0	4.30	0.100	0.076
CTRL5480F-1-102K	1000	1.0	5.50	0.092	0.060
CTRL5480F-1-122K	1200	1.0	6.30	0.082	0.060
CTRL5480F-1-152K	1500	1.0	7.20	0.075	0.060
CTRL5480F-1-182K	1800	1.0	9.60	0.068	0.046
CTRL5480F-1-222K	2200	1.0	11.5	0.062	0.046
CTRL5480F-1-272K	2700	1.0	13.0	0.054	0.046
CTRL5480F-1-332K	3300	1.0	17.0	0.049	0.036
CTRL5480F-1-392K	3900	1.0	19.0	0.045	0.036
CTRL5480F-1-472K	4700	1.0	24.0	0.043	0.030
CTRL5480F-1-562K	5600	1.0	29.0	0.040	0.030
CTRL5480F-1-682K	6800	1.0	42.0	0.037	0.024
CTRL5480F-1-822K	8200	1.0	60.0	0.035	0.018
CTRL5480F-1-103K	10000	1.0	70.0	0.034	0.018
CTRL5480F-1-123K	12000	1.0	75.0	0.033	0.018
CTRL5480F-1-153K	15000	1.0	110.0	0.031	0.015
CTRL5480F-1-183K	18000	1.0	125.0	0.029	0.015
CTRL5480F-1-223K	22000	1.0	135.0	0.018	0.015

CHARACTERISTICS

- Description:** Radial leaded fixed inductor.
- Applications:** Power supplies, Switching Regulators, SCR and TRIAC Controls, RFI Suppression, Filters, etc.
- Operating Temperature:** -55°C to $+125^{\circ}\text{C}$
- Saturation Current:** Based on the inductance change within 5% of initial value less than 30°C within coil body.
- Inductance Tolerance:** $\pm 10\%$
- Testing:** Inductance is tested on an HP4285A at the specified frequency.
- Packaging:** Bulk pack.
- Marking:** Parts are marked with inductance code.
- Miscellaneous:** **RoHS Compliant.**
- Additional Information:** Additional electrical & physical information available upon request.
- Samples available. See website for ordering information.**

PHYSICAL DIMENSIONS

Size	A	B	C	D	E	F
mm	5.7 \pm 1.27	7.3 \pm 1.27	9.5 \pm 1.27	15.8 \pm 1.27	0.50	2.0 \pm 1.27
inches	0.225 \pm 0.050	0.290 \pm 0.050	0.375 \pm 0.050	0.625 \pm 0.050	0.020	0.080 \pm 0.050

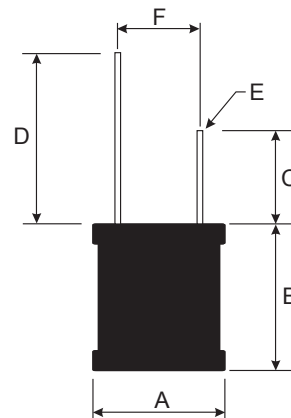

Note: Leads easily formable to "F" dimension.